

Junction Box - Blank / Transparent Cover

Material: ABS for Box (Thermoplastic material)
 Polycarbonate for Transparent Cover
 Nylon / Stainless Steel for Screws

Temperature Range: -25°to +60 Operating Temp.

Ingress Protection Rating: IP65

- * 650C Glow wire test
- * Knock-out / Cable sleeve Entries
- * Impact Resistant
- * Halogen Free
- * Color RAL7035 (L.Grey)
- * Unbreakable (IK07 / IK10)

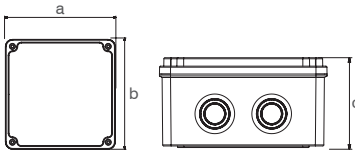

* All other size options available upon request...



Code Blank Door	Code Transparent Door	Dimensions		
		A mm	B mm	C mm
OJB101050		100	100	50
OJB111174	OJTB111174	110	110	74
OJB121580	OJTB121580	120	150	80
OJB151580	OJTB151580	150	150	80
OJB191580	OJTB191580	190	150	80
OJB211274	OJTB211274	210	120	74
OJB202080	OJTB202080	200	200	80
OJB261580	OJTB261580	260	150	80
OJB282174	OJTB282174	280	210	74
OJB382890	OJTB382890	380	280	90



85x85x40

Square White Junction Box (IP40 Only)

OSJB858540



85x85x50

Square Junction Box (IP40 Only)

OSJB858550



85x85x50

Square Junction Box (IP40 Only)

OSJBW858550



80x120x55

Junction Box (IP40 Only)

OSJBW801255

OSJTBW801255