

Standard Cable Lugs

Material: Copper

Tin plated against corrosion

Temperature Range: -40° to +105

Standard: DIN46228

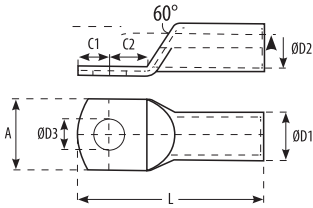

Code	Cable Section mm ²	Bolt	Dimensions					Packing Unit (pc.)
			D3	D2	D1	L	A	
OSCL10M5	10	M5	5,2	4,7	6,5	27,5	10,5	800
OSCL10M6		M6	6,5	4,7	6,5	27,5	10,5	800
OSCL10M8		M8	8,5	4,7	6,5	27,5	13,0	800
OSCL16M6	16	M6	6,5	5,8	7,4	30,0	12,0	500
OSCL16M8		M8	8,5	5,8	7,8	30,0	12,0	500
OSCL25M6	25	M6	6,5	7,0	9,2	40,0	14,0	350
OSCL25M8		M8	8,5	7,0	9,2	40,0	14,0	350
OSCL25M10		M10	10,5	7,0	9,2	40,0	14,0	350
OSCL35M6	35	M6	6,5	8,2	10,7	44,0	15,3	200
OSCL35M8		M8	8,5	8,2	10,7	44,0	15,3	200
OSCL35M10		M10	10,5	8,2	10,7	44,0	15,3	200
OSCL35M12		M12	13,0	8,2	10,7	44,0	15,3	200
OSCL50M8	50	M8	8,5	10,2	12,8	52,0	20,0	150
OSCL50M10		M10	10,5	10,2	12,8	52,0	20,0	150
OSCL50M12		M12	13,0	10,2	12,8	52,0	20,0	150
OSCL70M8	70	M8	8,5	11,7	14,7	55,0	22,0	100
OSCL70M10		M10	10,5	11,7	14,7	55,0	22,0	100
OSCL70M12		M12	13,0	11,7	14,7	55,0	22,0	100
OSCL95M8	95	M8	8,5	13,6	16,7	59,0	26,0	80
OSCL95M10		M10	10,5	13,6	16,7	59,0	26,0	80
OSCL95M12		M12	13,0	13,6	16,7	59,0	26,0	80
OSCL12M10	120	M10	10,5	15,5	19,0	70,0	29,0	50
OSCL12M12		M12	13,0	15,5	19,0	70,0	29,0	50
OSCL15M10	150	M10	10,5	16,7	21,0	77,0	32,0	40
OSCL15M12		M12	13,0	16,7	21,0	77,0	32,0	40
OSCL18M10	185	M10	10,5	18,8	23,0	85,0	35,0	30
OSCL18M12		M12	13,0	18,8	23,0	85,0	35,0	30
OSCL18M16		M16	17,0	18,8	23,0	85,0	35,0	30
OSCL24M10	240	M10	10,5	21,2	26,0	90,0	38,5	25
OSCL24M12		M12	13,0	21,2	26,0	90,0	38,5	25
OSCL24M16		M16	17,0	21,2	26,0	90,0	38,5	25